

MapPro Environmental Data

5353 West Alabama, Suite 303 Houston, TX 77056

Ph: (713) 789-0288 Fax: (713) 789-7223

<http://www.mapproenv.com/>

Water Well Search

Job No:	demo_ww	Client Information:	Demo Company 111 Company St Ste 111 DemoCity, TX 11111
Date:	7/12/2005	Site Information:	1655 Hwy 35 Bypass Alvin, TX 77511 Brazoria County

Notice of Disclaimer

ALL MATERIALS AND SERVICES ARE PROVIDED ON AN "AS IS" AND "AS AVAILABLE" BASIS WITHOUT WARRANTY OF ANY KIND, EITHER EXPRESSED OR IMPLIED, INCLUDING, BUT NOT LIMITED TO, THE IMPLIED WARRANTIES OF MERCHANTABILITY OR FITNESS FOR A PARTICULAR PURPOSE, OR THE WARRANTY OF NON-INFRINGEMENT.

Due to the limitations, constraints, inaccuracies and incompleteness of government information and computer mapping data currently available to MapPro Environmental Data, certain conventions have been utilized in preparing the locations of all federal, state and local agency sites residing in MapPro Environmental Data's databases. All Sites are depicted by a point representing their approximate location and make no attempt to represent the actual areas of the associated property. Actual boundaries and locations of individual properties can be found in the files residing at the agency responsible for such information.

Waiver of Liability

Although MapPro Environmental Data uses its best efforts to research the actual location of each site, MapPro Environmental Data does not and cannot warrant the accuracy of these sites with regard to exact location and size. All authorized users of MapPro Environmental Data's services are signifying an understanding of MapPro Environmental Data's searching and mapping conventions and agree to waive any and all liability claims associated with search and map results showing incomplete and or inaccurate site locations.

YOUR EXCLUSIVE REMEDY AND MAPPRO ENVIRONMENTAL DATA'S ENTIRE LIABILITY, IF ANY, FOR ANY CLAIMS, OTHER THAN THOSE WAIVED ABOVE ARISING OUT OF THESE TERMS OF USE AND YOUR USE OF THIS INFORMATION SHALL BE LIMITED TO THE AMOUNT PAID FOR THE DATA BASE REPORT GIVING RISE TO THE LIABILITY.

IN NO EVENT SHALL MAPPRO ENVIRONMENTAL DATA OR ITS AFFILIATES BE LIABLE TO YOU OR ANY THIRD PARTY FOR ANY SPECIAL, PUNITIVE, INCIDENTAL, INDIRECT OR CONSEQUENTIAL DAMAGES OF ANY KIND, OR ANY DAMAGES WHATSOEVER, INCLUDING, WITHOUT LIMITATION, THOSE RESULTING FROM LOSS OF USE, DATA OR PROFITS, WHETHER OR NOT MAPPRO ENVIRONMENTAL DATA HAS BEEN ADVISED OF THE POSSIBILITY OF SUCH DAMAGES, AND ON ANY THEORY OF LIABILITY, ARISING OUT OF OR IN CONNECTION WITH THE USE OF THIS DATA.

WATER WELL MAP

Project #:

Site Name:

Property Location: 1655 Hwy 35 Bypass, Alvin, TX 77511, Brazoria County

Map Scale 1 in. = 830' Approx

Topo Info: Algoa, Texas 1995

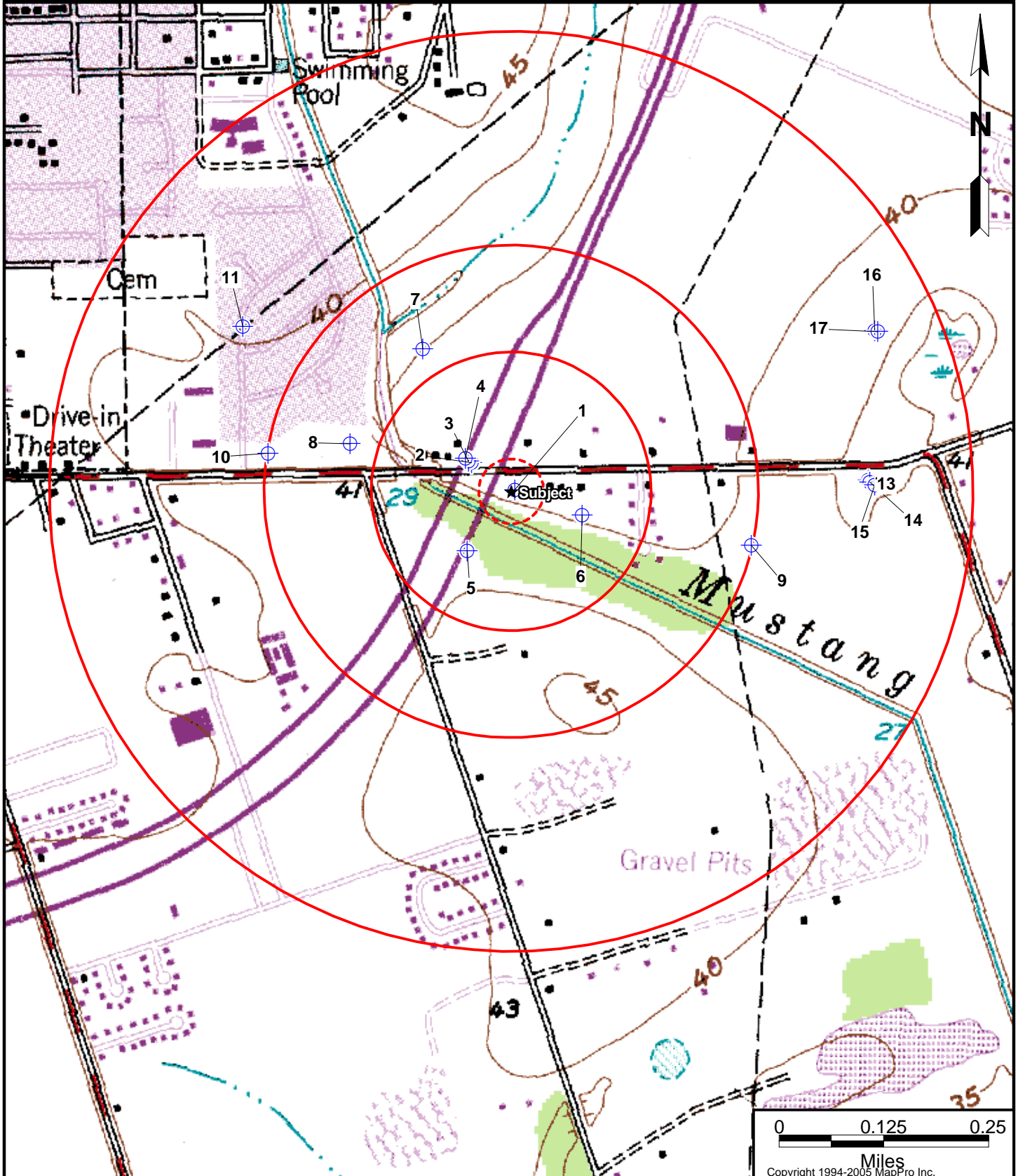

CAUTION:

The location of property arrows shown on this map are approximate only. Inaccuracies may exist on map such as missing, incorrectly drawn, or incorrectly addressed streets. Please report any such inaccuracy to MapPro Environmental Data so that appropriate corrections can be made.

Copyright 1994-2005 MapPro Inc.

WATER WELL MAP

Project #:

Site Name:

Property Location: 1655 Hwy 35 Bypass, Alvin, TX 77511, Brazoria County

Map Scale 1 in. = 480' Approx

Topo Info: Algoa, Texas 1995

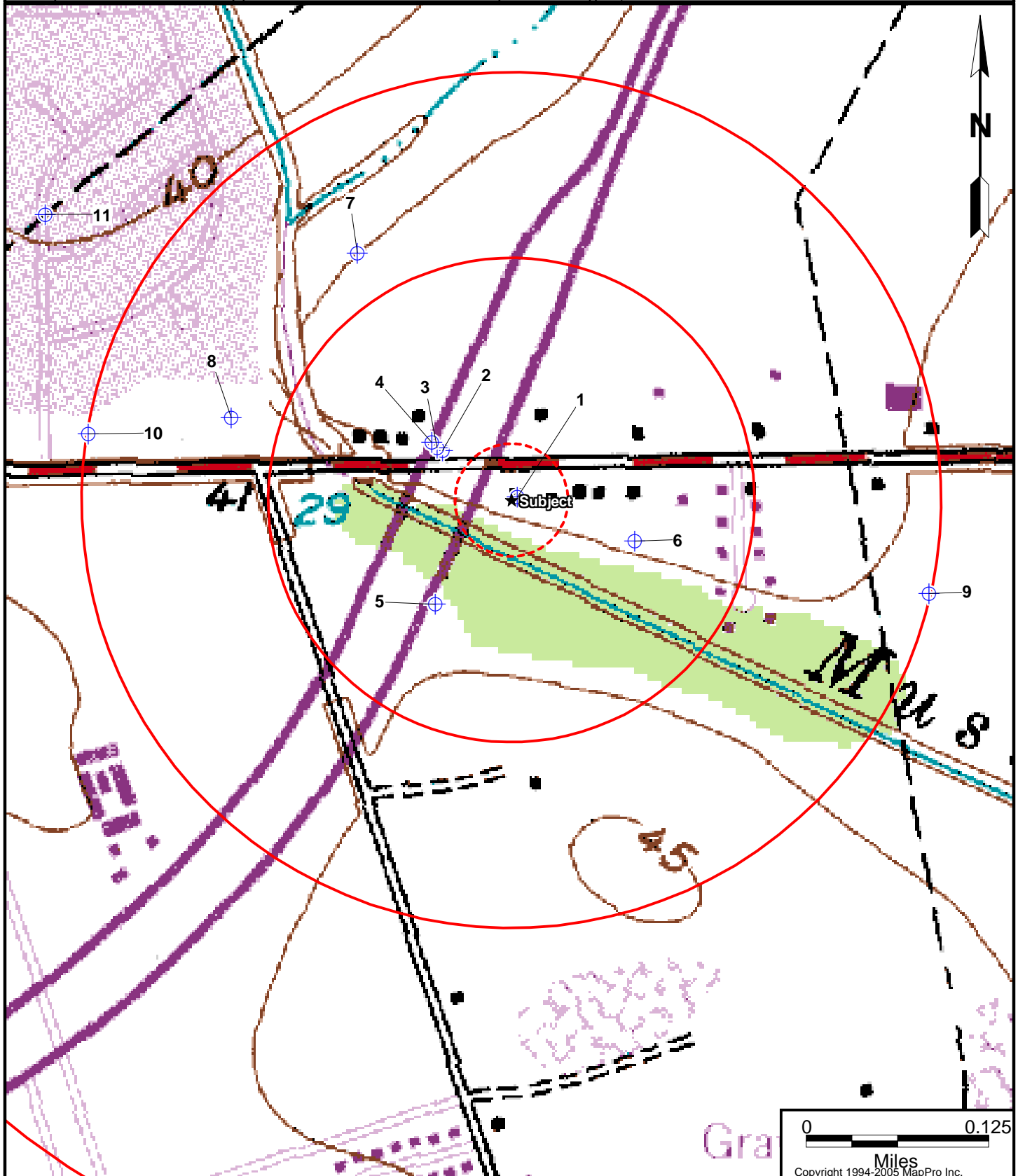

CAUTION:

The location of property arrows shown on this map are approximate only. Inaccuracies may exist on map such as missing, incorrectly drawn, or incorrectly addressed streets. Please report any such inaccuracy to MapPro Environmental Data so that appropriate corrections can be made.

0 0.125
Miles
Copyright 1994-2005 MapPro Inc.

WELL INVENTORY

Property And Surrounding Areas (all sites within 1/8 mi)

Facility Owner	Distance	Well #	Map ID	Date Drilled	Well Type
Gulf Oil Corp	On-Site	65-39-7	1	10/01/1969	Withdrawal
Mitchell, Don	0.019 NW	65-39-7	2	10/11/1994	Domestic
Rainy Sr, Tim	0.023 NW	65-39-7	3	05/02/1995	Domestic
Riley, Ed	0.028 NW	65-39-7	4	02/10/1995	Domestic
Mayfield, Gary & Cathy	0.049 SW	65-39-7	5	08/17/1992	Domestic
Leno Leder	0.049 E	65-39-7HH	6	04/01/1978	Domestic

Surrounding Sites (between 1/8 mi and 1/4 mi)

Facility Owner	Distance	Well #	Map ID	Date Drilled	Well Type
Paul Platt	0.158 NW	65-39-7BBB	7	02/19/1985	Domestic
Robert O. Karns	0.158 W	65-39-7Q	8	07/10/1974	Domestic
Frank Larvin	0.249 E	65-39-7SS	9	09/28/1980	Domestic
Joe Garcia	0.249 W	65-39-7	10	01/05/1999	Domestic

Surrounding Sites (between 1/4 mi and 1/2 mi)

Facility Owner	Distance	Well #	Map ID	Date Drilled	Well Type
Lillian Nation	0.329 NW	65-39-7R	11	03/25/1983	Domestic
Larry Bottoms	0.378 E	65-39-7HH	12	02/26/1983	Domestic
P.L. Curtiss	0.38 E	65-39-7HH	13	01/26/1979	Stock
Carl Jones	0.38 E	65-39-7HH	14	01/11/1981	Domestic
	0.385 E	65-39-7	15		Domestic
Lesikar, Woodrow	0.425 NE	65-39-7H	16	03/1973	Domestic
Allen Webb	0.428 NE	65-39-7H	17	04/24/1980	Domestic

Unplottable Sites within Grid

Facility Owner	Distance	Well #	Map ID	Date Drilled	Well Type
Smith, Lewis	Unplotted	Unk		08/10/1992	Domestic

Property Location: 1655 Hwy 35 Bypass
Alvin, TX 77511

DATABASES SEARCHED**Texas Water Development Board (TWDB)**

This agency maintains locations and well information of the water wells it has inventoried. The locations are mapped on USGS topographic maps and on county highway maps. Both types of maps have been reviewed for this search.

Texas Commission on Environmental Quality

This agency (Formerly TNRCC) maintains the files of all water well logs submitted to the Water Well Drillers Board that have not been incorporated into the Water Development Board's located well records. Initially these well records were given a state well number and plotted on a county highway map based on the information submitted by the driller. These wells are referred to as plotted wells. Multiple plotted wells may have the same well number. In 1986, the state stopped plotting these wells. These wells were given a partial well number that corresponds to the geographical groundwater section they are filed in. For this reason, these wells are referred to as partially numbered wells. All groundwater files concerning these three types of well records have been reviewed for this search.

USGS

The USGS maintains information on 1.5 million wells nationwide to investigate the occurrence, quantity, quality, distribution and movement of surface and underground waters. State and local governments, public and private utilities, and other Federal agencies are involved with managing the water resources.