

# MapPro Environmental Data

5353 West Alabama, Suite 303 Houston, TX 77056

Ph: (713) 789-0288 Fax: (713) 789-7223

<http://www.mapproenv.com/>

## Oil and Gas Map

<b>Job No:</b>	oilgas_sample	<b>Client Information:</b>	Demo Company 111 Company St Ste 111 DemoCity, TX 11111
<b>Date:</b>	7/11/2005	<b>Site Information:</b>	Sample Oil and Gas Well Map 11603 N Houston Rosslyn Rd Houston, TX 77086 Harris County

### Notice of Disclaimer

ALL MATERIALS AND SERVICES ARE PROVIDED ON AN "AS IS" AND "AS AVAILABLE" BASIS WITHOUT WARRANTY OF ANY KIND, EITHER EXPRESSED OR IMPLIED, INCLUDING, BUT NOT LIMITED TO, THE IMPLIED WARRANTIES OF MERCHANTABILITY OR FITNESS FOR A PARTICULAR PURPOSE, OR THE WARRANTY OF NON-INFRINGEMENT.

Due to the limitations, constraints, inaccuracies and incompleteness of government information and computer mapping data currently available to MapPro Environmental Data, certain conventions have been utilized in preparing the locations of all federal, state and local agency sites residing in MapPro Environmental Data's databases. All Sites are depicted by a point representing their approximate location and make no attempt to represent the actual areas of the associated property. Actual boundaries and locations of individual properties can be found in the files residing at the agency responsible for such information.

### Waiver of Liability

Although MapPro Environmental Data uses its best efforts to research the actual location of each site, MapPro Environmental Data does not and cannot warrant the accuracy of these sites with regard to exact location and size. All authorized users of MapPro Environmental Data's services are signifying an understanding of MapPro Environmental Data's searching and mapping conventions and agree to waive any and all liability claims associated with search and map results showing incomplete and or inaccurate site locations.

YOUR EXCLUSIVE REMEDY AND MAPPRO ENVIRONMENTAL DATA'S ENTIRE LIABILITY, IF ANY, FOR ANY CLAIMS, OTHER THAN THOSE WAIVED ABOVE ARISING OUT OF THESE TERMS OF USE AND YOUR USE OF THIS INFORMATION SHALL BE LIMITED TO THE AMOUNT PAID FOR THE DATA BASE REPORT GIVING RISE TO THE LIABILITY.

IN NO EVENT SHALL MAPPRO ENVIRONMENTAL DATA OR ITS AFFILIATES BE LIABLE TO YOU OR ANY THIRD PARTY FOR ANY SPECIAL, PUNITIVE, INCIDENTAL, INDIRECT OR CONSEQUENTIAL DAMAGES OF ANY KIND, OR ANY DAMAGES WHATSOEVER, INCLUDING, WITHOUT LIMITATION, THOSE RESULTING FROM LOSS OF USE, DATA OR PROFITS, WHETHER OR NOT MAPPRO ENVIRONMENTAL DATA HAS BEEN ADVISED OF THE POSSIBILITY OF SUCH DAMAGES, AND ON ANY THEORY OF LIABILITY, ARISING OUT OF OR IN CONNECTION WITH THE USE OF THIS DATA.

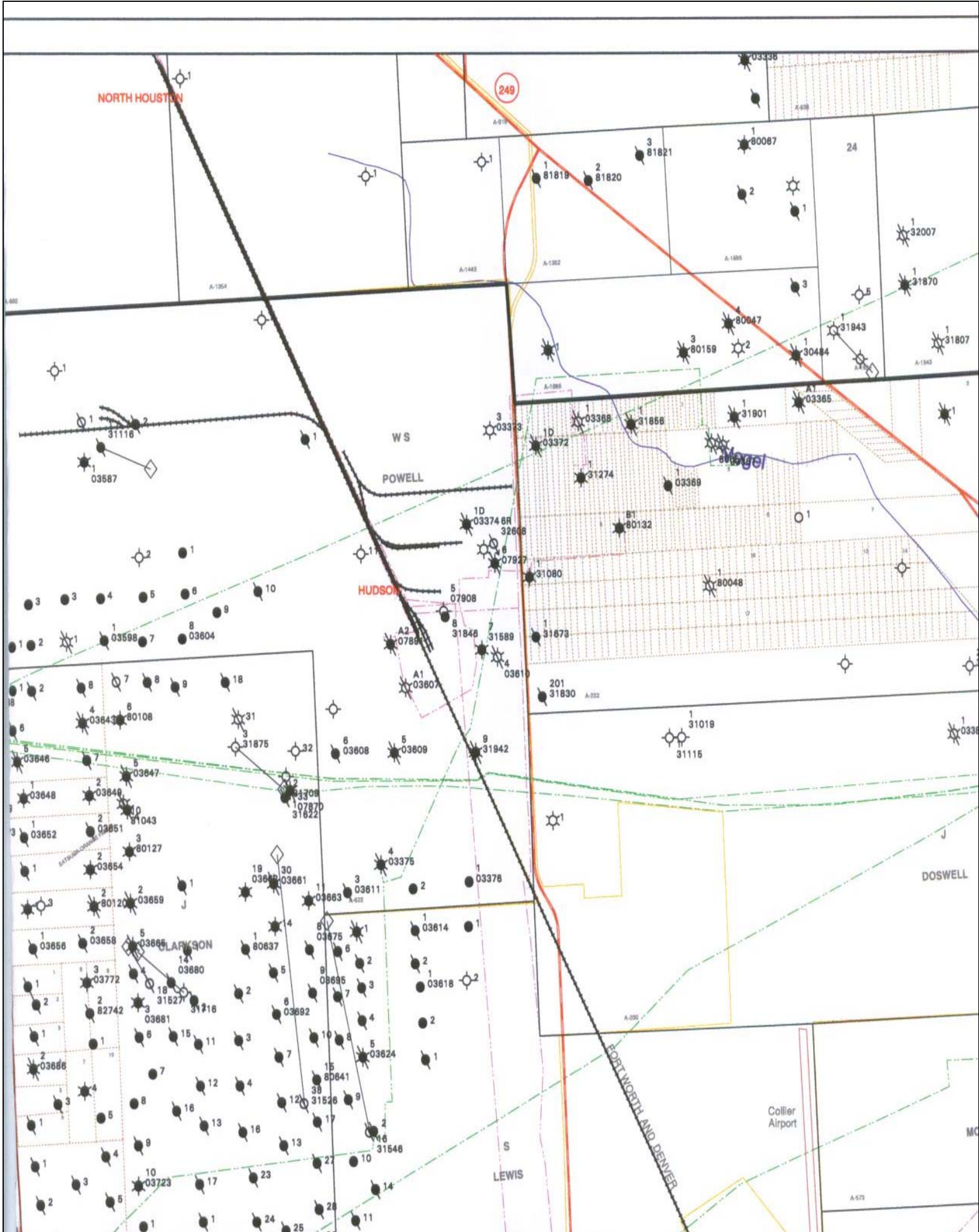





Source: TEXAS RRC  
 Scale: 1"=2000'

Date: 5-20-2005



RAILROAD COMMISSION OF TEXAS  
WELL LOCATION DATABASE  
MAP LEGEND

○ State Highway	 Interstate Highway	 Farm / Ranch Road
◌ State Highway	 U.S. Highway	 Park Road

WELL SYMBOLS

<ul style="list-style-type: none"> <li>○ Proposed Location</li> <li>⊗ Cancelled Location</li> <li>⊕ Dry Hole</li> <li>● Oil</li> <li>☆ Gas</li> <li>★ Oil / Gas</li> <li>⊗ Plugged Oil</li> <li>⊗ Plugged Gas</li> <li>⊗ Plugged Oil / Gas</li> <li>⊗ Injection or Disposal</li> <li>⊙ Storage</li> <li>⊙ Oil Storage</li> <li>⊙ Gas Storage</li> <li>△ Radioactive</li> <li>⊗ Injection or Disposal from Oil</li> <li>⊗ Injection or Disposal from Gas</li> <li>⊗ Injection or Disposal from Oil / Gas</li> </ul>	<ul style="list-style-type: none"> <li>♀ Geothermal</li> <li>⊗ Brine Mining Injection</li> <li>⊗ Water Supply</li> <li>⊗ Water Supply from Oil</li> <li>⊗ Water Supply from Gas</li> <li>⊗ Water Supply from Oil / Gas</li> <li>⊗ Observation</li> <li>⊗ Observation from Oil</li> <li>⊗ Observation from Gas</li> <li>⊗ Observation from Oil / Gas</li> <li>● Shut-In Oil</li> <li>⊗ Shut-In Gas</li> <li>⊗ Core Test (one or more holes)</li> <li>♂ Sulfur Test (one or more holes)</li> <li>⬡ Horizontal Drainhole</li> <li>◇ Directional Well Surface Location</li> <li>◇ Sidetrack Well Surface Location</li> </ul>
--	--

